

cs PORTAL LM

Sliding door hardware
for light alloy elements

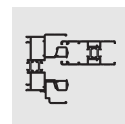
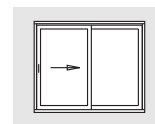

... with these decisive advantages:

- simple locking on the locking side
- easy adjustment to frame due to special striker plates
- elegant ergonomic finger pull handle

Size range

Sash rebate height	(mm)	to profile manufacturer's details
Sash rebate width	(mm)	to profile manufacturer's details
Sash weight	(kg)	max. 100

The size range given above must never be exceeded.

In addition the details given by the profile manufacturer or the system owner apply to SIEGENIA-AUBI-CS-PORTAL LM hardware, **particularly** to possible constraints to sash dimensions and sash weight.

Contents

Size range.....	Page 1	cs LM 100 bogie wheels tech. data sheet	Page 5
Hardware summary	Page 2	Fitting the shell handle	Page 6
Hardware list	Page 3	Important notes, Abbreviations	Page 7
Sash and frame dimensions.....	Page 4	Striker plates and locking hooks	Page 8

Assembly instruction
CSgb4004

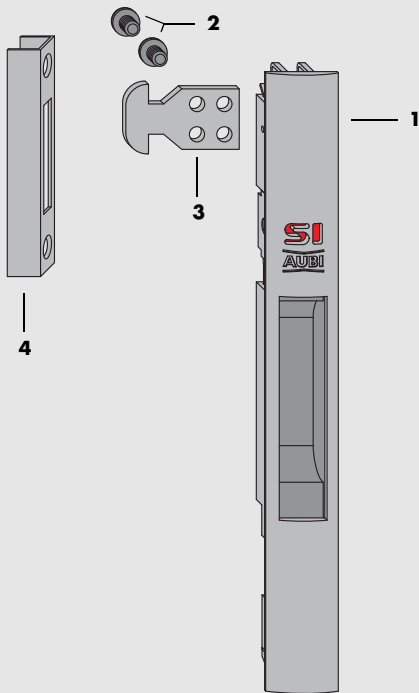

- 1** CS LM shell handle
- 2** Screws
- 3** CS LM locking hook
- 4** CS LM Striker plate
- 5** CS LM 100 bogie wheels

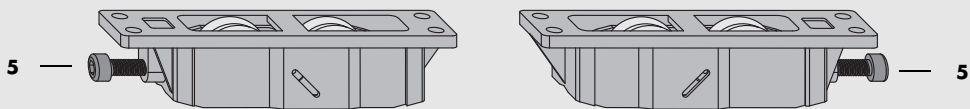

For bogie wheels see Tech. Data Sheet Page 5

cs PORTAL LM with finger pull handle Hardware List

	Ref.	Qty.	Material brief description	Material No.		
				White RAL 9016	Black RAL 9005	Si-silver
generally required		1	CS LM shell handle <i>comprising:</i>	PHIM0010-004010	PHIM0010-023010	PHIM0010-025010
	1	1	CS LM Shell handle			
	2	2	Screws <i>for fixing the locking hook</i>			
profile dependent	3	1	VCS LM locking hook Exec A0272 Exec A0274 Exec A0275 Exec A0276		PFZM0010-000010 PFZM0020-000010 PFZM0030-000010 PFZM0040-000010	
	4	1	CS LM striker plate Exec A0272 Exec A0274 Exec A0275 Exec A0276		PRTM0010-000010 PRTM0020-000010 PRTM0030-000010 PRTM0040-000010	
	5	2	CS LM 100 bogie wheels Sash weight max. 100 kg		PLWM0010-099010	

Note: This hardware list applies to schemes with one sliding sash

Fixing the hardware components

- CS LM finger pull handle(**1**): Clamping device
- CS LM 100 bogie wheels(**5**): Self tapping screw B 4.8 x ..
- CS LM striker plate: Countersunk self tapping screw B 4.8 x ..
Screws B 4.8 x .. , Steel transparent zinc coated (not supplied)
Screw lengths depend on profile system.

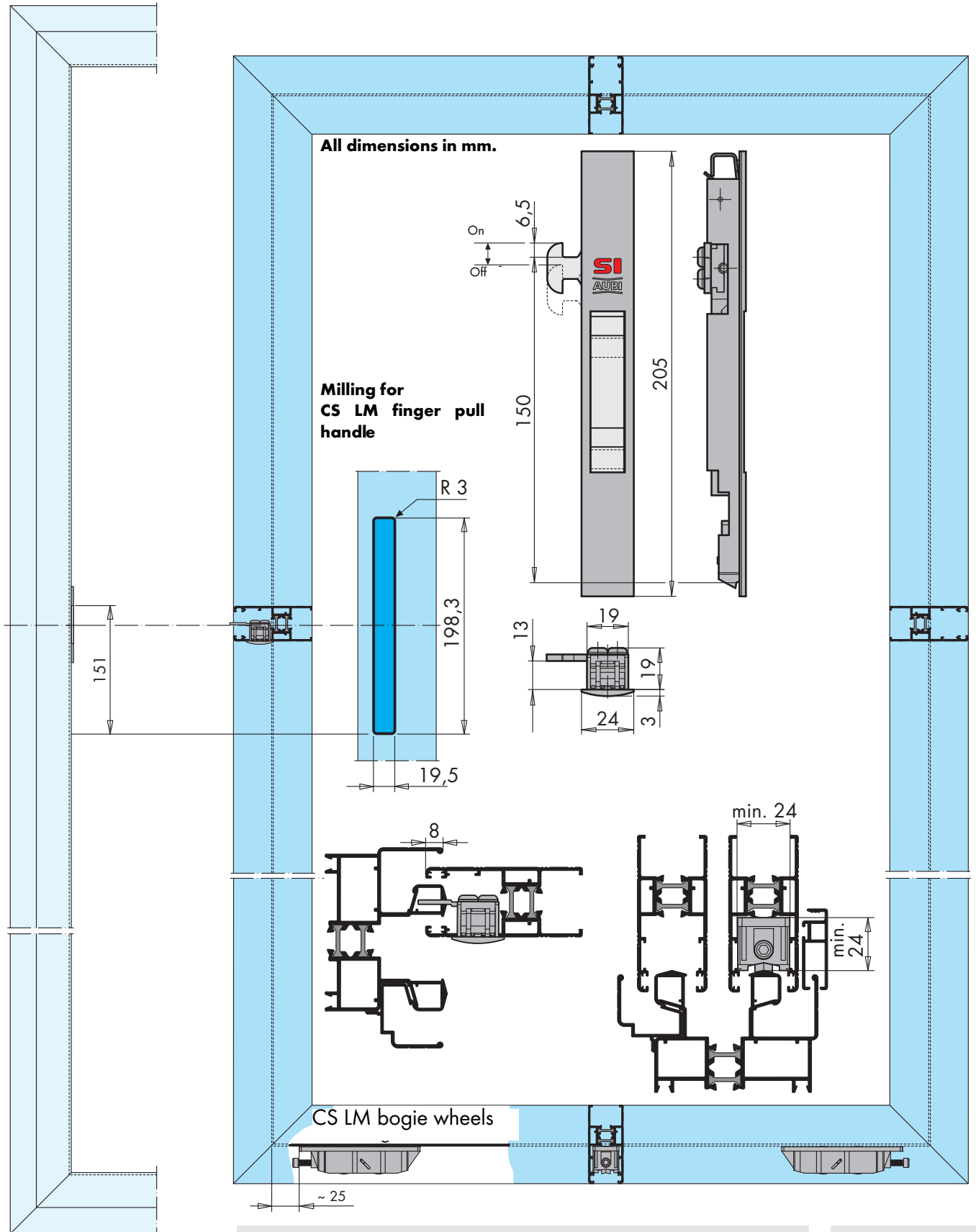

Fitting on window frame

Screw on CS LM striker plate (4) to suit dimensions and function

Fitting on sash frame

- A Cut location opening for CS LM finger pull handle (1).
- B Insert CS LM finger pull handle (1) push upwards and engage at bottom.
- C Insert CS LM bogie wheels (5) into sliding sash and screw on tightly.

Final assembly

- A Insert sliding sash into window frame.
- B Check function.

All dimensions in mm

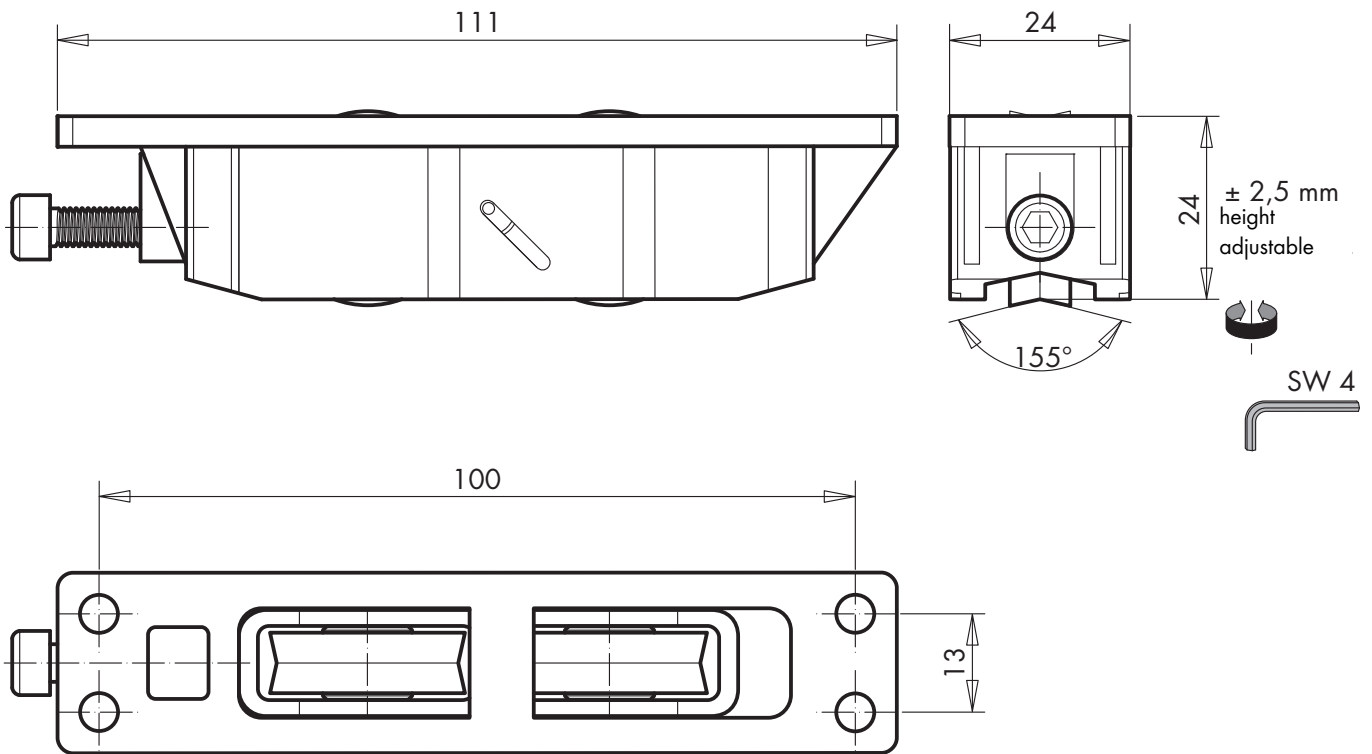

Self tapping screw B 4.8 x ... supplied by customer.

- For running rails with running lip angle of 155°
- Carrying capacity max. 100 kg/pair of bogie wheels
- Ball bearing raced bogie wheels

cs **PORTAL LM** with finger pull handle *Fitting the handle*

1. Insert the handle in the aperture.
2. Push the handle upwards in the aperture.
3. Press the handle into the aperture

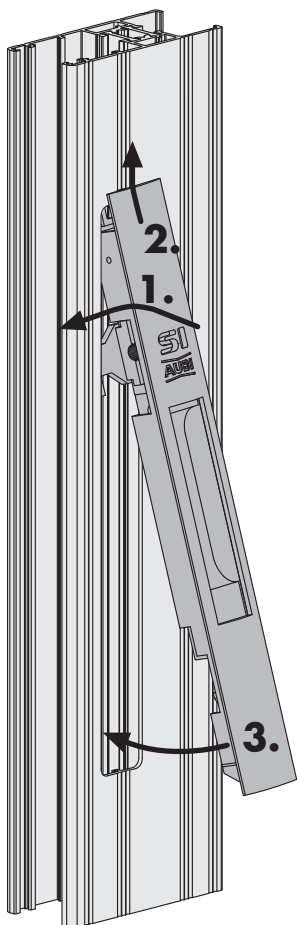

4. Push the handle downwards in the aperture.

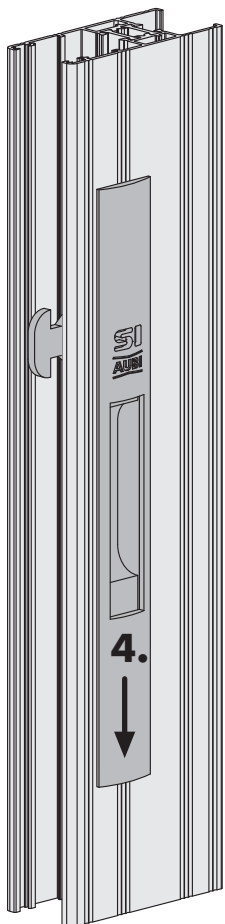

Important notes

- Always comply with our Product Information „Sliding hardware for the sashes of patio doors and windows“.
 - For SIEGENIA-AUBI cs-PORTAL LM hardware **the size ranges specified on Page 1 must never be exceeded.**
In addition to this the details given by the profile manufacturer, particularly on possible restrictions to sash dimensions and sash weight, apply to the SIEGENIA-AUBI cs-PORTAL LM hardware. Details given on screwing speeds and torques are binding. Where specific manufacturing regulations or working guidelines exist, these are to be expressly observed. The hardware components described in these Assembly Instructions made of steel are zinc electroplated and then treated with a special process. They must not be used:
 - in damp rooms
 - in environments containing aggressive, corrosion promoting air
 - in environments with salty air
- In such cases please consult your SIEGENIA representative.
- Put together the whole of the hardware using only SIEGENIA-AUBI hardware components and the accessory parts specified by the profile manufacturer. Otherwise damage can occur, for which we accept no liability.
 - Fit all hardware components properly as described in these Assembly Instructions. **Do not overtighten screws!**
 - Follow the standard techniques for packing and wedge the sealed glazing units within the sash/frame.
 - Do not use acid curing sealants, as these can cause corrosion of the hardware components.
 - Keep the running lips of the running rail and the threshold and also all rebates free from dirt and debris - especially residues of cement or plaster. Avoid the direct effect of moisture on the hardware and any contact with cleaning agents.

Liability exclusions

We accept no liability in respect of any damages or malfunctions caused by the hardware components or the sliding elements fitted with them, as a result of incorrect or inappropriate specification or other information provided by the customer, failure to follow these instructions or an exertion of excessive force to the hardware (e.g. due to usage not complying with the directions).

We accept no liability in respect of any damages or malfunctions to the hardware components or the sliding elements fitted with them, if:

- the fitting was not carried out in line with our Assembly Instructions and the general rules of the technology,
- the hardware has been damaged by the application of force, by misuse or by external influences,
- unauthorised alterations have been made to the hardware,
- unapproved hardware components from other ranges or other manufacturers are also used; this applies to unapproved combinations of hardware components with different surface finishes,
- the hardware has been serviced at least once a year in accordance with our cs-PORTAL Maintenance Instructions,
- the end user has not been informed about our Maintenance Instructions and suitable instructed.

We specifically point out that the hardware components must be cleaned regularly; in particular the Guide Rail and Running rail must be kept clean for troublefree use.

Abbreviations

The following abbreviations are used in these Assembly Instructions:

Bl.	Bag
FB	FSash width
FH	Sash height
RAB	Frame outer width
RAH	Frame outer height

cs PORTAL LM Striker plates and Locking hooks

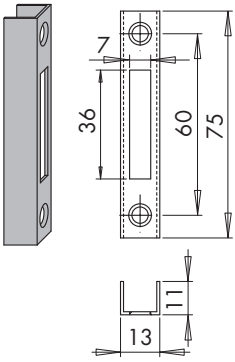

Striker plate A 0272

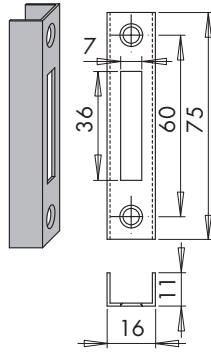

Striker plate A 0274

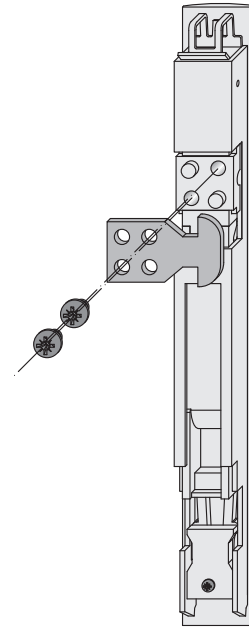

Secure locking hook with enclosed screws (2).

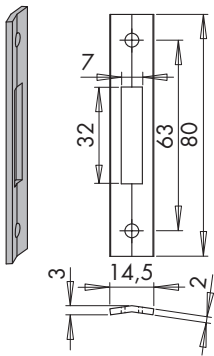

Striker plate A 0275

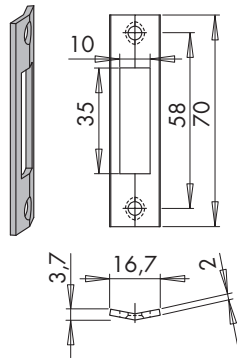

Striker plate A 0276

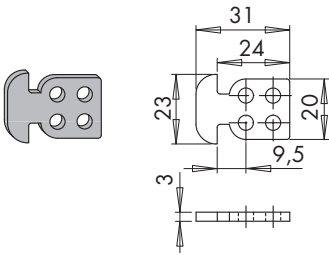

Locking hook A 0272

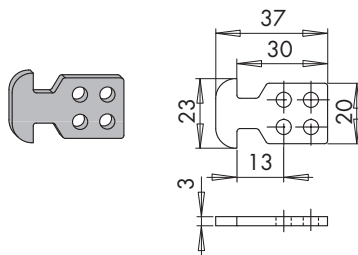

Locking hook A 0274

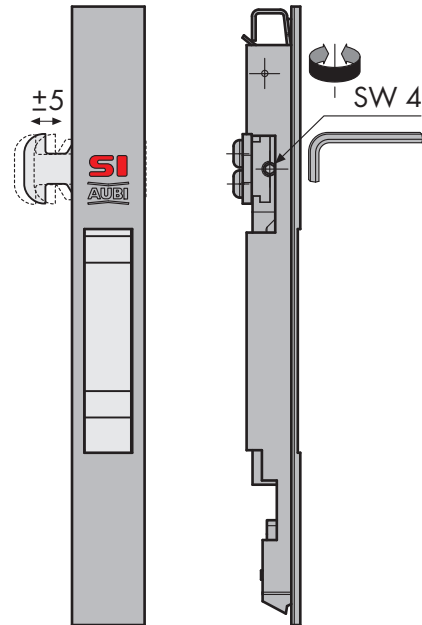

Locking hook can be adjusted 3 mm A/F hexagon wrench.

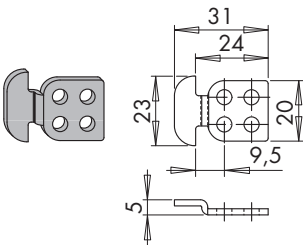

Locking hook A 0275

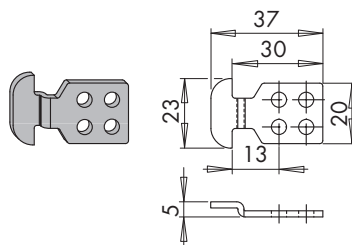

Locking hook A 0276