

ALU

Maintenance instructions:

ALU axxent PLUS, ALU 2200, ALU 5100, ALU 5200, ALU-DK/TBT200, ALU-D300,
AU RB/SF

Window systems

Door systems

Comfort systems

Content

1	TARGET GROUP OF THIS DOCUMENTATION.....	3
2	IMPORTANT INFORMATION.....	3
3	MAINTENANCE AND SERVICE (ONLY BY SPECIALISED WINDOW FABRICATORS).....	3
4	MAINTENANCE, CLEANING AND SURFACE PROTECTION	3
5	EXPLANATION OF SYMBOLS.....	4
6	FEEDBACK ON DOCUMENTATION.....	4
7	MAINTENANCE INSTRUCTIONS ALU AXXENT PLUS-DK/TBT	5
8	MAINTENANCE INSTRUCTIONS ALU AXXENT PLUS-D	6
9	MAINTENANCE INSTRUCTIONS ALU 2200.....	7
10	MAINTENANCE INSTRUCTIONS ALU 5100.....	8
11	MAINTENANCE INSTRUCTIONS ALU 5200	9
12	MAINTENANCE INSTRUCTIONS ALU-DK/TBT200 10	
13	MAINTENANCE INSTRUCTIONS ALU-D300	11
14	MAINTENANCE INSTRUCTIONS ALU-RB/SF	12

1 Target group of this documentation

- This documentation is intended for use by specialists and end users only.

2 Important information

- Your windows/French doors are equipped with high-quality SIEGENIA hardware. To ensure that the ease of movement and proper functioning is retained for as long as possible, we recommend that the following maintenance and inspection work is carried out at regular intervals (at least once a year, twice a year in school and hotels).

3 Maintenance and service (only by specialised window fabricators)

- Grease or oil all movable hardware components and all locking points.
Use only acid-free and resin-free oil or grease.
- Use a grease spray on the movable parts in the window sash and spray into all openings in the hardware.
Then move the hardware into position several times until the grease is distributed.
- Wipe off any excess oil or grease.
- Grease the strikers in the window frame using a firm grease (consistency class 2 in accordance with DIN 51818) in those places where the locking cam engages with the striker.
Our maintenance grease is particularly suited for this. You can order it from SIEGENIA under the material number ZXSX0120-093010.
- Check that all safety-relevant hardware components (□) are secure and check for wear.
- These maintenance instructions also apply to hardware and window types, which are not specifically described here.

4 Maintenance, cleaning and surface protection

- When treating surfaces (e.g. painting or glazing your windows/French doors), remove all hardware components and protect them from any stains which may result from this treatment.
- Remove any stains or spills immediately because they could impair functioning and damage the surface protection of the hardware.
- Use only mild, pH-neutral, diluted cleaning agents.
- Never use sharp objects, abrasives or aggressive cleaning agents (such as vinegar or acidic cleaning agents) as they could damage the corrosion protection of the hardware.
- When cleaning, ensure that no water runs into the hardware.
- Dry the hardware thoroughly after cleaning and oil the surface with a non-acidic and non-resinous oil by wiping it with an oil-impregnated cloth.
- Certain climatic conditions cause "condensation" of glass, frames and other window components. Regulation and abundant ventilation will prevent the occurrence of condensation water. Open all windows for approx. 5 minutes 3 – 4 times a day after using the rooms.
- Further information on maintenance and inspection can be found in the "Directives of the Trade Organisation for Locks and Fittings (Gütegemeinschaft Schlösser und Beschläge e. V.)" (<http://www.beschlagindustrie.de/ggsb/richtlinien.asp>).

5 Explanation of symbols



Lubrication point (oil/grease)



Greasing points (grease)



Standard adjustment point



Safety-related area



Attention



Observe note

6 Feedback on documentation

We welcome your comments and suggestions on how to improve our documentation.

Please email your comments to documentation@siegenia.com



7 ALU axxent PLUS-DK (-TBT)

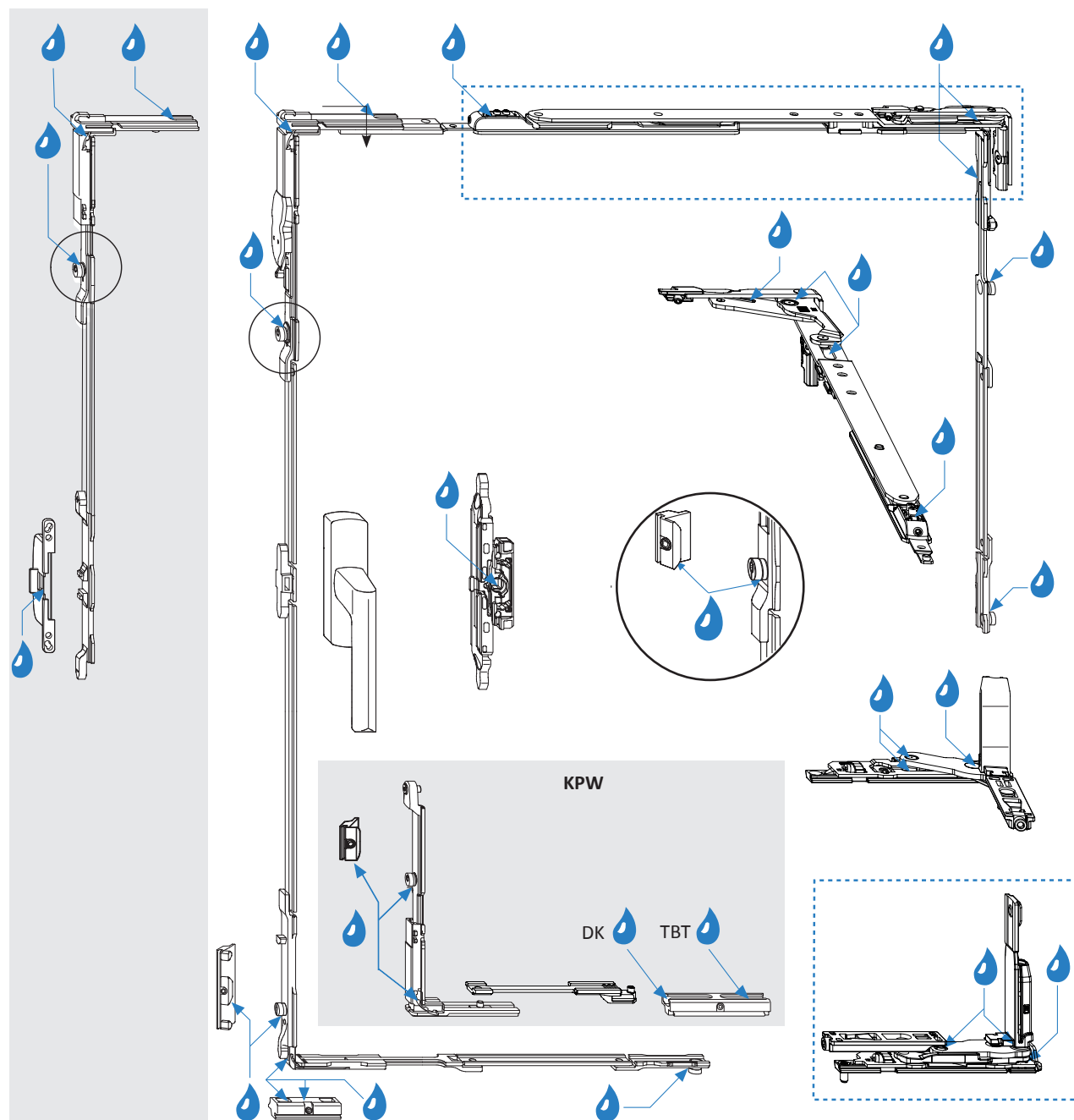

-For further information, please refer to the H48.
axntLS...en assembly instructions.

-Please observe the notes and explanations on
pages 3 and 4!



8 ALU axxent PLUS-D

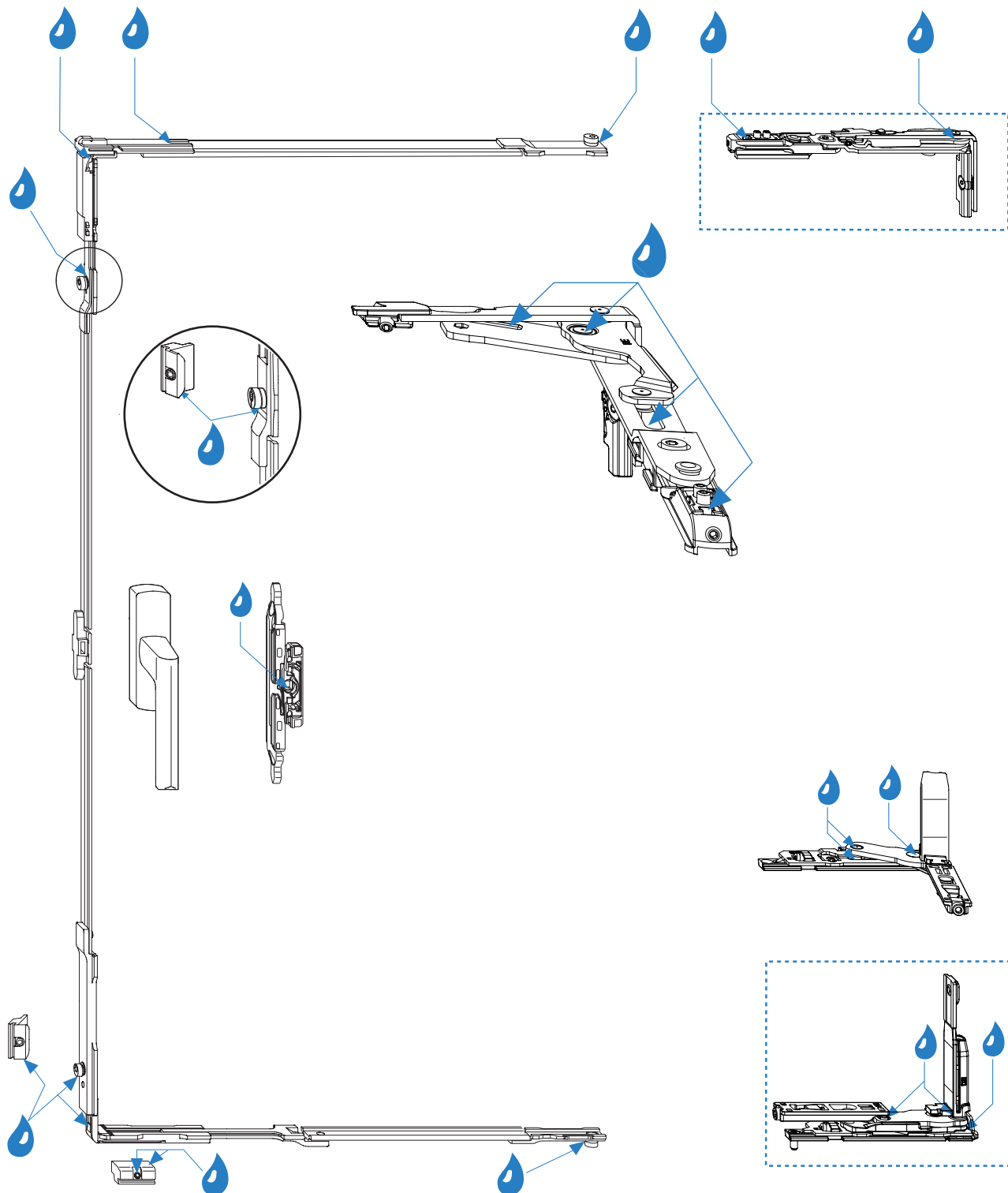

-For further information, please refer to the H48.
axntLS...en assembly instructions.

-Please observe the notes and explanations on
pages 3 and 4!



9 ALU 2200-DK (-TBT)

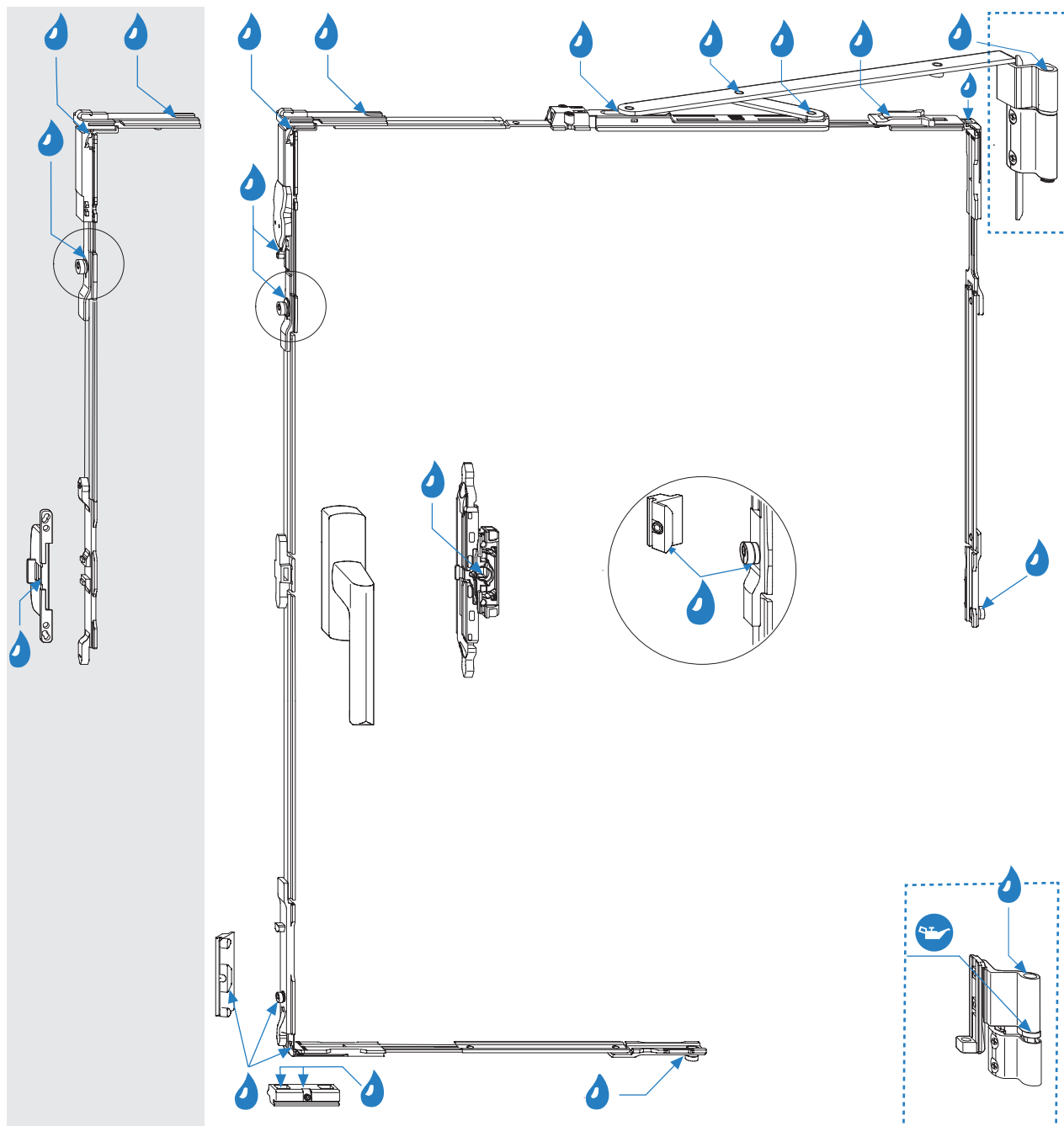

Note: Grease the joint of the bottom hinge pins, **do not oil!**



-For further information, please refer to the H48.2200LS...en assembly instructions.

-Please observe the notes and explanations on pages 3 and 4!

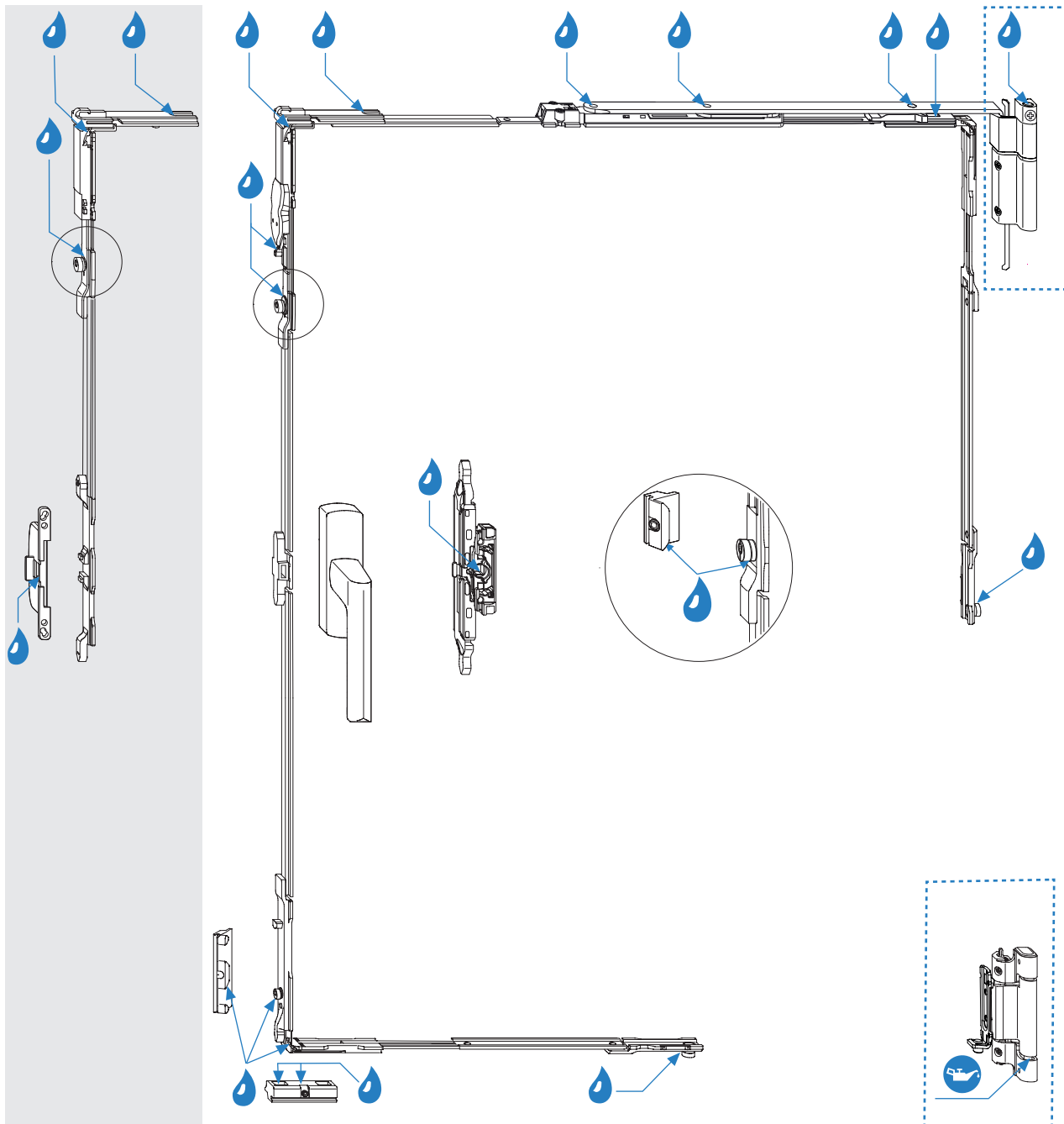
**10 ALU 5100-DK (-TBT)**

Note: Grease the joint of the bottom hinge pins, **do not oil!**



-For further information, please refer to the H48.5100LS...en assembly instructions.

-Please observe the notes and explanations on pages 3 and 4!



11 ALU 5200-DK (-TBT)

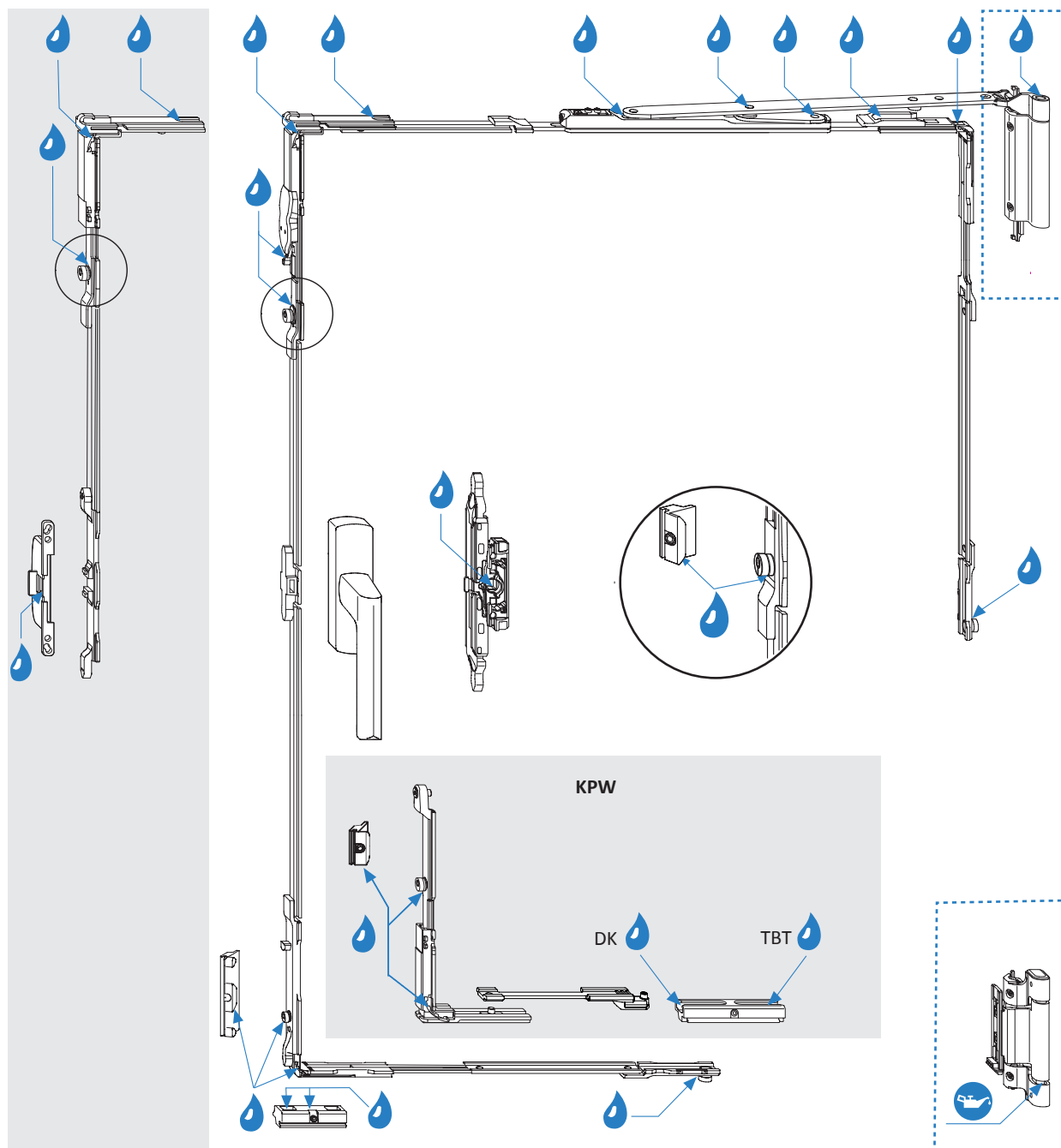

Note: Grease the joint of the bottom hinge pins, **do not** oil!



--For further information, please refer to the H48.5200LS...en assembly instructions.

-Please observe the notes and explanations on pages 3 and 4!



12 ALU-DK200 (-TBT200)

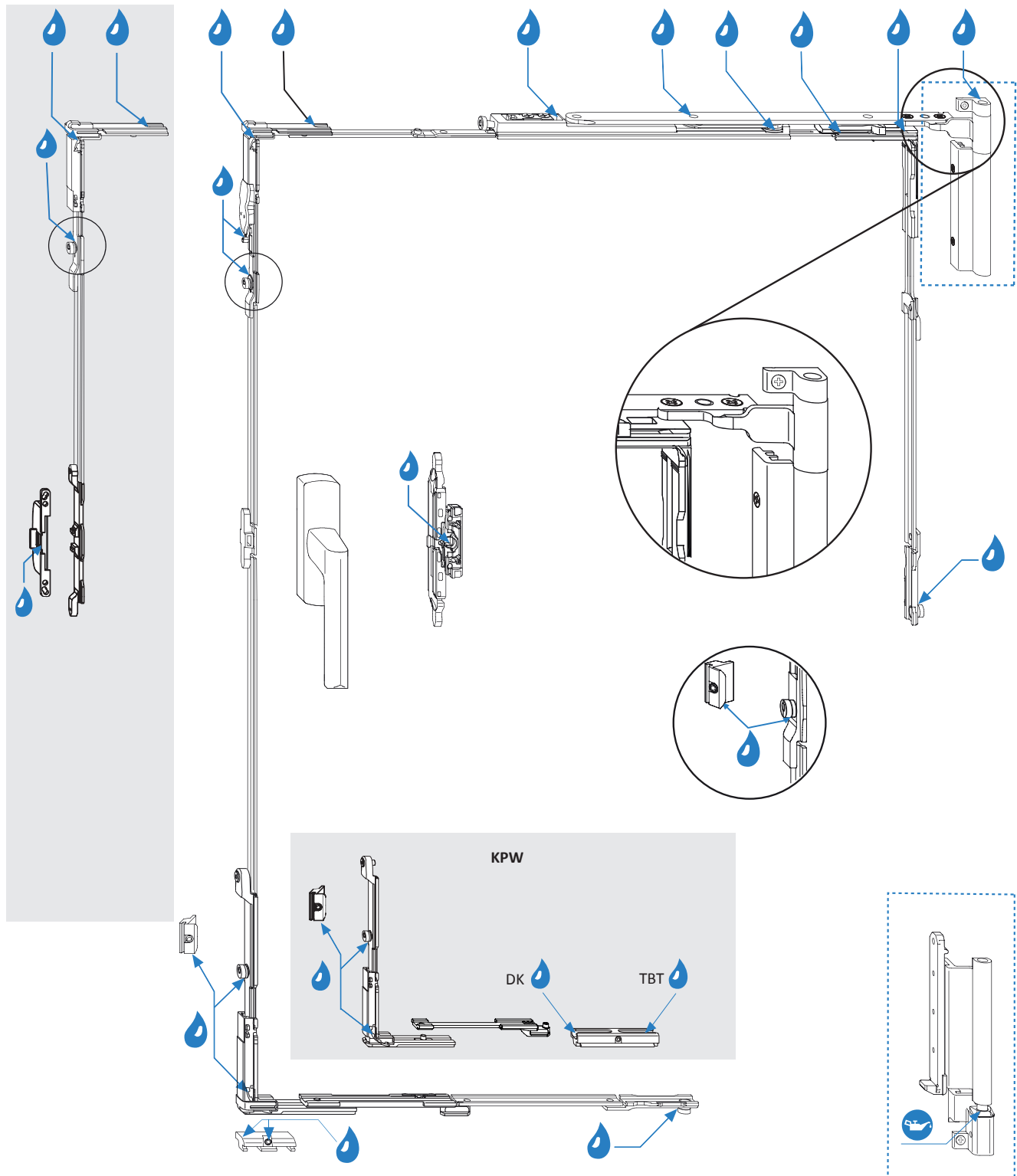

Note: Grease the joint of the bottom hinge pins, **do not oil!**



-For further information, please refer to the H48.5200LS...en assembly instructions.

-Please observe the notes and explanations on pages 3 and 4!



13 ALU-D300

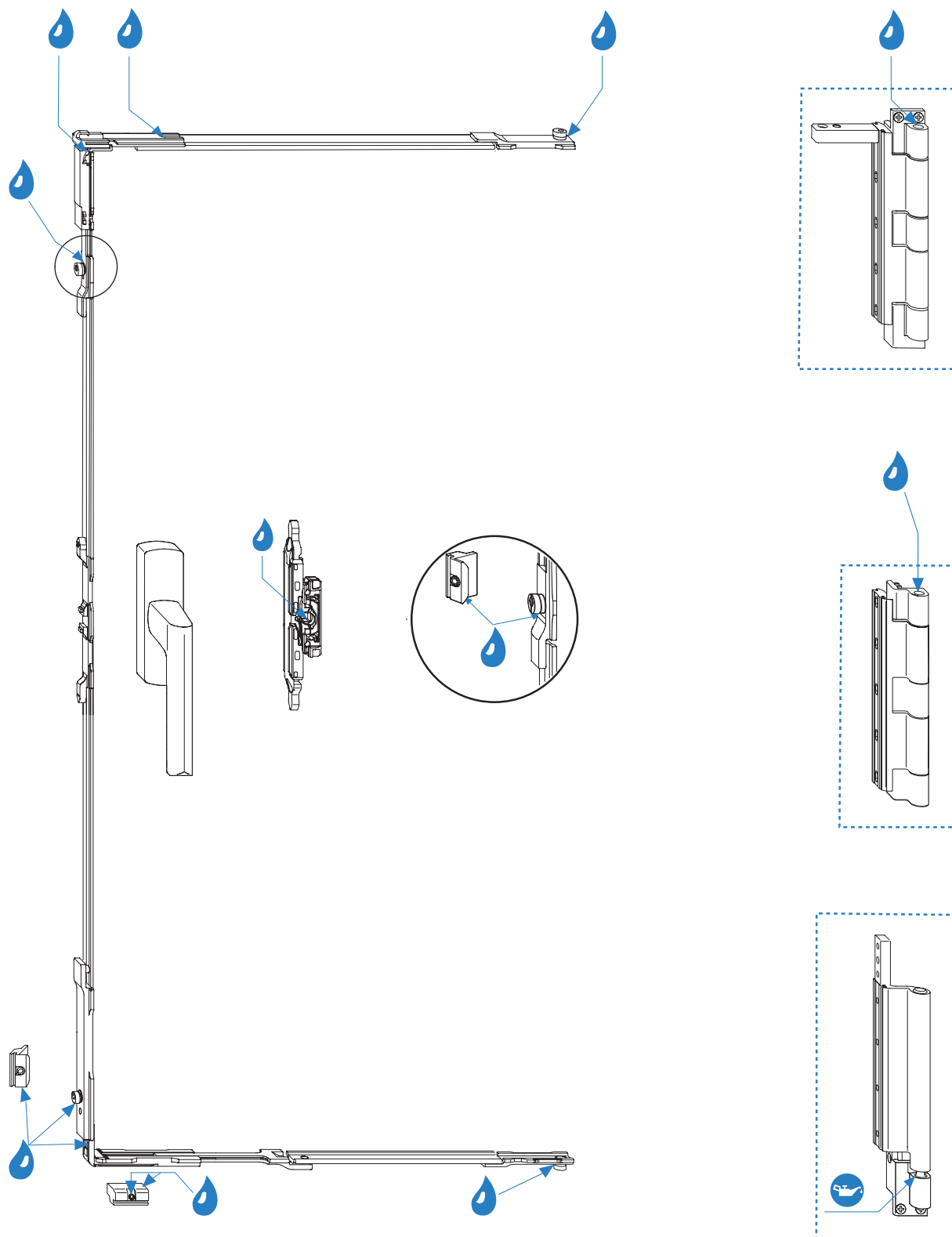

Note: Grease the joint of the bottom hinge pin, **do not oil!**



-For further information, please refer to the
H48.300LS...en assembly instructions.

-Please observe the notes and explanations on pages
3 and 4!



14 ALU-RB/ALU-SF

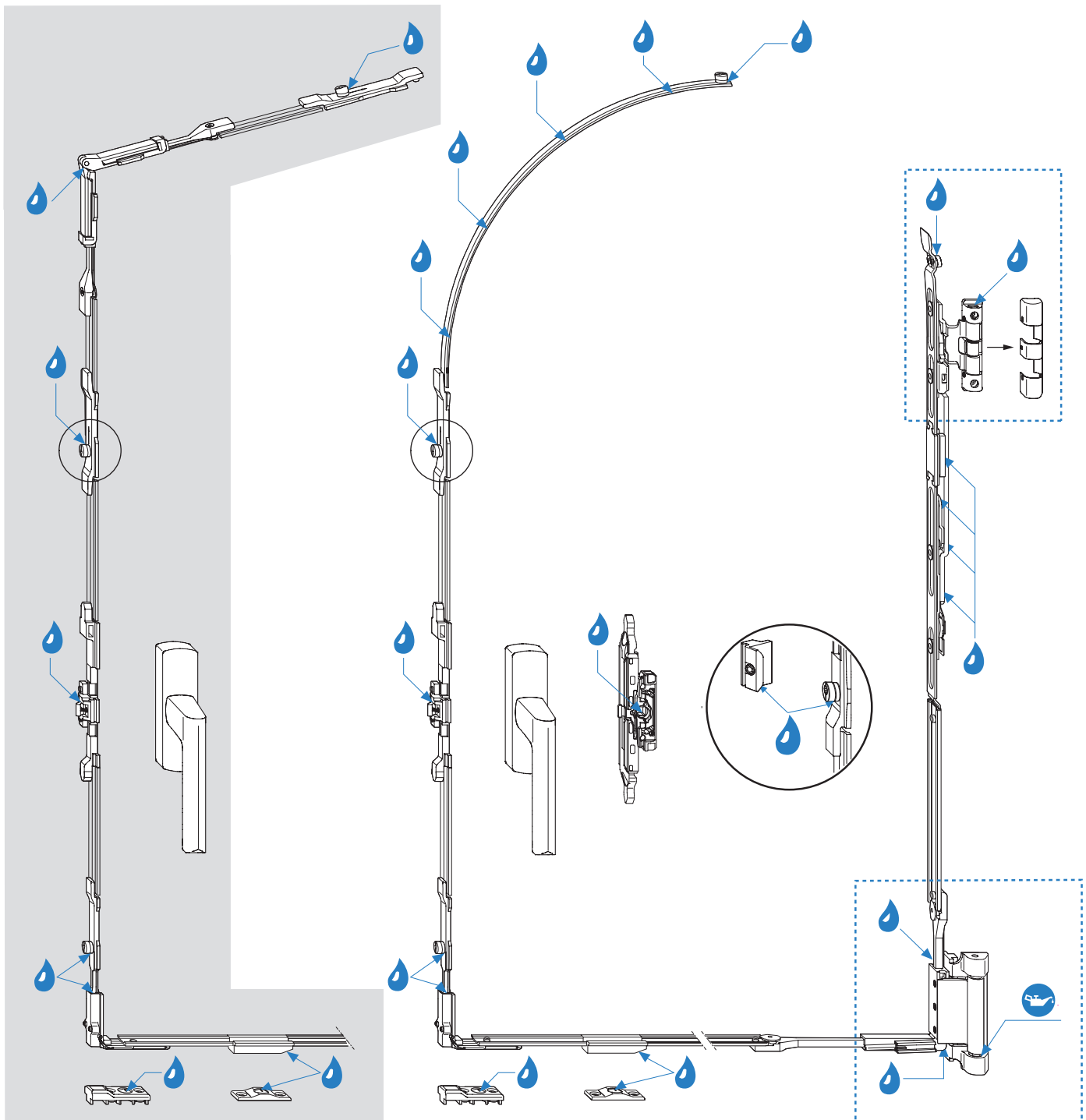

Note: Grease the joint of the bottom hinge pins, **do not** oil!



-For further information, please refer to the H48.
RBLS...en or H48.SFLS...en assembly instructions.
-Please observe the notes and explanations on
pages 3 and 4!

www.siegenia.com



SIEGENIA®
brings spaces to life